



Marlin

F-046



- IEEE 1394a camera
- Modular design
- Robust housing
- Machine vision camera

基本描述

Compact, flexible, modular IEEE 1394a Wide VGA C-Mount camera

The Marlin F-046B/F-046C is equipped with a very sensitive Sony ICX415 CCD sensor. It runs at 52.71 frames per second at full resolution and Format_7. Higher frame rates can be reached by using a smaller area of interest (AOI) and binning.

性能参数

| | |
|-----------|---------------------------------------|
| Marlin | F-046 |
| 接口 | IEEE 1394a - 400 Mb/s, 1 port |
| 分辨率 | 780 (H) × 582 (V) |
| 传感器 | Sony ICX415 |
| 传感器类型 | CCD Progressive |
| 传感器尺寸 | Type 1/2 |
| 像元尺寸 | 8.3 μm × 8.3 μm |
| 标准镜头接口 | C-Mount |
| 最大满帧帧率 | 52 fps |
| ADC | 12 bit |
| 缓存 (RAM) | 8 MByte |
| | 输出 |
| Bit位数 | 8-10 bit |
| 黑白像素格式 | Mono8, Mono16 |
| RGB彩色像素格式 | RGB8 |
| 原始像素格式 | Raw8 |
| | 通用输入输出(GPIOs) |
| 光耦 I/Os | 2 inputs, 2 outputs |

| | |
|---------------------|--|
| Marlin | F-046 |
| RS232 | 1 |
| 工作条件/尺寸 | |
| 工作温度 | +5 °C to +45 °C |
| 电源要求 (DC) | 8 V to 36 V |
| 功耗 | <3 W (@ 12 VDC) |
| 重量 | <120 g |
| 尺寸(L × W × H in mm) | 72 × 44x 29 (including connectors) |
| 符合规范 | CE: 2014/30/EU (EMC), 2011/65/EU (RoHS); FCC Class B |

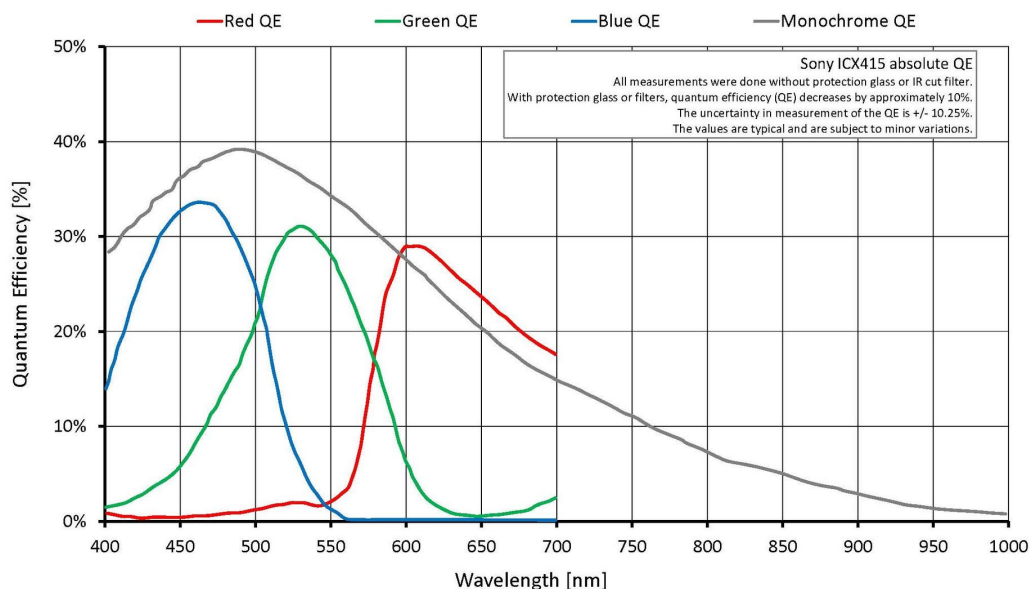

特性

Marlin cameras are equipped with many useful real-time image pre-processing functions. They are performed by the FPGA inside the camera – with no additional CPU load on the host, so that an inexpensive system is sufficient.

- Programmable look-up table (LUT), white balance, hue, saturation
- Debayering
- Gain
 - Auto/manual
 - Manual gain control: 0 to 24 dB
- Exposure
 - Auto/manual



- Exposure time: 32 μ s to 67 s
- Color correction
- Shading correction
- Sub-sampling, 2x binning (b/w)
- Area of interest (AOI) with speed increase
- Sequence mode - changes the image settings on the fly
- Image mirror
- Deferred image transport
- SIS (secure image signature, time stamp for trigger, frame count)
- Storable user settings

外形尺寸

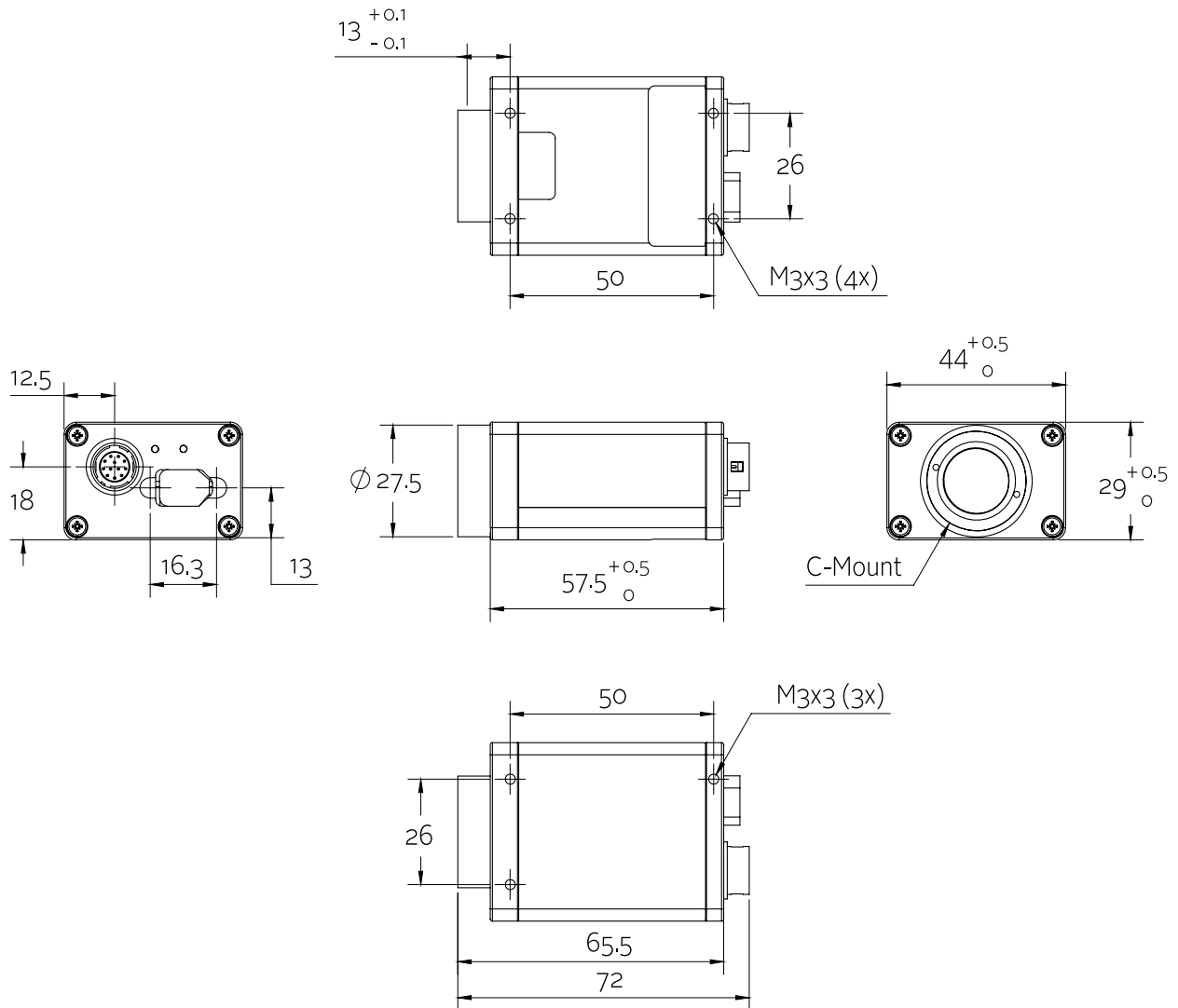



应用场景

With its modular and flexible design and the real-time pre-processing functions, this Marlin camera fits for many applications:

- Machine vision
- Quality control
- Semiconductor inspection
- Industrial inspection